

Stainless non-return valve RX® fig. 808 with hinged valve

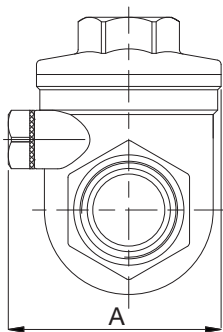

stainless steel non-return valve with BSP female connection for water, light duty and gas applications

- Material body** : stainless steel, GX5CrNiMo19-11-2 (1.4408)
- Material bonnet** : stainless steel, GX5CrNiMo19-11-2 (1.4408)
- Material seal** : stainless steel, GX5CrNiMo19-11-2 (1.4408)
- Shaft** : stainless steel, X5CrNiMo17-12-2 (1.4401)
- Sealing shaft** : PTFE
- Connection** : both sides BSP female connection as per BS 21
- Operating pressure** : PN16:
 - max. 16 bar at 38 °C
 - max. 1 bar at 180 °C



All non-return valves in accordance with PED 97/23/EC

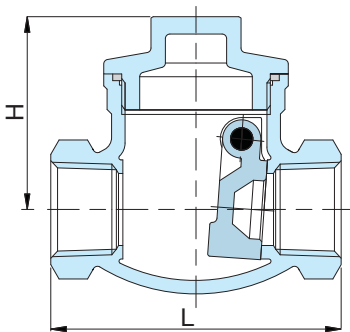

Tabel 1: Dimensions fig. 808

BSP			3/8"	1/2"	3/4"	1"	1.1/4"	1.1/2"	2"	2.1/2"	3"
L	mm	65	65	65	80	89	105	120	139	181	200
H	mm	43	43	43	50	60	66	75	80	99	104
A	mm	47	47	47	52	56	64	75	84	111	152
weight	kg	0.36	0.36	0.36	0.43	0.66	0.93	1.49	2.15	5.27	7.7

The information provided in this document is for general information purposes only and does not constitute advice. ERIKS shall not be liable for any damages resulting from the use of this document, including but not limited to damages caused by any incorrectness or incompleteness of the provided information, unless such damage is the result of any willful misconduct or gross negligence on part of ERIKS.

For more information, a quotation or an order please contact one of our specialists on number +31 (072) 514 18 00

ERIKS bv • P.O. box 280 • 1800 BK Alkmaar • phone (072) 514 15 14 • fax (072) 515 56 45 • info@eriks.nl • www.eriks.nl